

STANLEY®

WATERPROOF LITHIUM-ION LED FLASHLIGHT

INSTRUCTION MANUAL

TL10PS

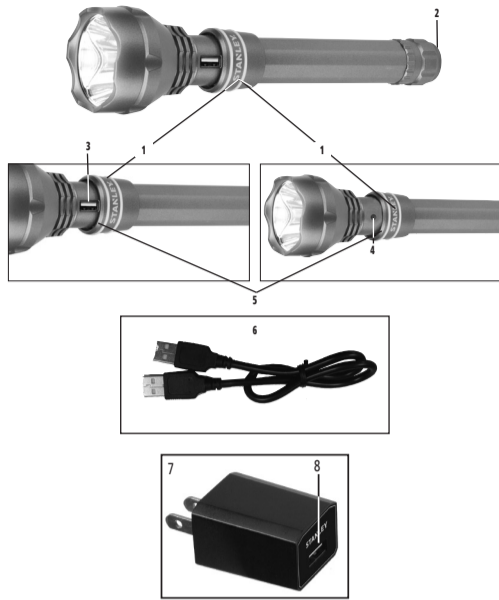

SAVE THIS INSTRUCTION MANUAL FOR FUTURE REFERENCE.

Copyright © 2018
Baccus Global LLC, Boca Raton, FL 33432
(877) 571-2391



SAFETY GUIDELINES / DEFINITIONS

- DANGER:** Indicates an imminently hazardous situation which, if not avoided, will result in death or serious injury.
 - WARNING:** Indicates a potentially hazardous situation which, if not avoided, could result in death or serious injury.
 - CAUTION:** Indicates a potentially hazardous situation which, if not avoided, may result in minor or moderate injury.
- CAUTION:** Used without the safety alert symbol indicates potentially hazardous situation which, if not avoided, may result in property damage.
- RISK OF UNSAFE OPERATION.** When using tools or equipment, basic safety precautions should always be followed to reduce the risk of personal injury. Improper operation, maintenance or modification of tools or equipment could result in serious injury and property damage. There are certain applications for which tools and equipment are designed. Manufacturer strongly recommends that this product NOT be modified and/or used for any application other than for which it was designed. Read and understand all warnings and operating instructions before using any tool or equipment.

IMPORTANT SAFETY INSTRUCTIONS

READ ALL INSTRUCTIONS

WARNING: Read all instructions before operating flashlight. Failure to follow all instructions listed below may result in electric shock, fire and/or serious injury.

GENERAL SAFETY WARNINGS AND INSTRUCTIONS

- WARNING:** This product or its power cord contains lead, a chemical known to the State of California to cause cancer and birth defect or other reproductive harm. Wash hands after handling.
- #### INSTRUCTIONS PERTAINING TO RISK OF FIRE, ELECTRIC SHOCK, OR INJURY TO PERSONS
- WARNING – WHEN USING ELECTRICAL APPLIANCES, BASIC PRECAUTIONS SHOULD ALWAYS BE FOLLOWED, INCLUDING THE FOLLOWING:**
 - The flashlight, the optional 120 volt AC/USB charging adapter and the supplied charging cable are not toys and cannot be played with as toys. To reduce the risk of injury, close supervision is necessary when these are used near children.
 - Use only attachments recommended or sold by the manufacturer.
 - WARNING – TO REDUCE THE RISK OF ELECTRIC SHOCK:**
 - Charge indoors only.
 - Do not expose the supplied charging cable, the 120 volt AC/USB charging adapter or battery to moisture, water or any other liquid.
 - Use only the 120 volt AC/USB charging adapter and/or USB charging cable supplied by the manufacturer to recharge.
 - WARNING – FIRE HAZARD:** Keep flashlight lamp away from materials that may burn.
 - CAUTION – TO REDUCE THE RISK OF INJURY OR PROPERTY DAMAGE:**
 - The LED gets hot quickly. Do not touch the hot lens, guard or enclosure.
 - Never place the light face down on any surface when lit, charging or not in use. Never store the light face down on any surface.
 - Never look directly into the light or shine the light into another person's eyes.
 - Keep sharp objects away from lens — it can crack or break.
 - Do not expose this unit to extremely high temperatures.
 - Do not drop or throw flashlight. It contains a lithium-ion battery pack.
 - Use only with the 120 volt AC/USB charging adapter and/or the USB charging cable provided with the unit. Plug in the charging cable at the flashlight first, then plug into the charging source.
 - After charging/recharging, disconnect charging cable and wait 5 minutes before use.
 - Do not crush, cut, pull or expose the USB charging cable to extreme heat.
 - Position the charging cable so it does not become entangled or become a safety hazard. Keep the charging cable away from sharp edges.
 - Do not open the flashlight body casing. There are no user-serviceable parts inside.
 - Do not operate the flashlight without the lens in place.
 - To reduce risk of damage to the USB charging cable, pull by the plug rather than the cord when disconnecting.
 - Do not attempt to charge the unit if the USB charging cable or the 120 volt AC/USB charging adapter are damaged – contact customer service for replacement.

SPECIFIC SAFETY INSTRUCTIONS FOR LITHIUM-ION BATTERIES

- WARNING – TO REDUCE THE RISK OF FIRE, ELECTRIC SHOCK, BURST HAZARD, OR INJURY TO PERSONS OR PROPERTY:**
 - Lithium-ion batteries are small, compact and ideal for providing long-lasting power to this unit. However, they must be used and charged properly. Improper use can result in serious injury, fire, or death.
 - Lithium-ion batteries can explode in the presence of a source of ignition. Do not use the product in the presence of an open flame.
 - Do not place this lithium-ion battery powered unit in fire or apply heat to it.
 - Do not subject this lithium-ion battery powered unit to strong impacts or shocks. The battery in this unit contains safety and protection devices which, if damaged, may cause the battery to generate heat, rupture or ignite.
 - Do not expose the lithium-ion battery to water or salt water, or allow the battery to get wet.
 - Avoid storing this lithium-ion battery powered unit in the basement, bathroom or other areas of the house that are or may become wet or where humidity and moisture may concentrate.
 - Do not leave this lithium-ion battery powered unit in direct sunlight, or use or store the unit inside cars in hot weather. Doing so may cause the battery to generate heat, rupture, or ignite. Using the battery in this manner may also result in a loss of performance and a shortened life expectancy.
 - Never charge this unit near heat or flammable objects.
 - NEVER THROW WATER ON A BURNING LI-ION BATTERY! If a lithium-ion battery does catch on fire, it will burn even more violently if it comes in contact with water or even moisture in the air. A fire extinguisher must be used.**

Battery Charging and Capacity

This unit is delivered in a partially charged state – you must fully charge it before using it for the first time. When stored at room temperature with a full charge, Li-ion batteries will begin to discharge from the time they are manufactured, even when unused. Deep discharges also decrease their capacity. Battery life can be extended by the following:

- Charge battery to full capacity before storage.
- Optimal storage temperature for this unit is between 5°C and 20°C (41°F and 68°F).
- Never discharge the battery fully.

- Charge after each use.
- Always charge at least once every 3-6 months if not in frequent use to prevent overdischarge.

Transportation of lithium-ion batteries

- Always check all applicable local, national, and international regulations before transporting a unit containing a Lithium-ion battery.
- Transporting an end-of-life, damaged, or recalled battery may, in certain cases, be specifically limited or prohibited.

INSTRUCTIONS PERTAINING TO WATERPROOF FLASHLIGHTS

The rubber O-ring acts to preserve the waterproof qualities of the flashlight. The O-ring seals the charging port cover before use are very important.

CAUTION – TO REDUCE THE RISK OF PROPERTY DAMAGE:

- Attempting to remove the rubber O-ring, use of the unit with a damaged O-ring or lens, improper sealing of the waterproof charging port cover, and/or submerging this unit in water deeper than 6 feet (1.8 meters), for time longer than 2 hours and/or in temperatures other than between 41°F and 104°F (5°C and 40°C), may cause the unit to no longer be waterproof. Do not use the unit if these conditions exist or it could sustain permanent damage.

INSTRUCTIONS PERTAINING TO THE USB PORTS

- IMPORTANT:** Some household USB-powered electronics will not operate with the USB ports provided with this device. Check the manual of the corresponding electronic device to confirm that it can be used with this type of USB port.
- The USB ports do not support data communication.** They only provide power to an external USB powered device (5V DC/1A) using the USB port on the flashlight or AC/USB charging adapter. Make sure the rating of equipment plugged into the USB port does not exceed the amperage stated.
- Always connect the charging adapter to the 120 volt AC power source before plugging any devices into it.
- Do not attach USB hubs allowing connection of multiple personal electronic devices to the USB port on the charging adapter.

SAVE THESE INSTRUCTIONS

INTRODUCTION

Congratulations on purchasing your new *Stanley Lithium-ion LED Flashlight*. Read this Instruction Manual and follow the instructions carefully before using your new flashlight.

FEATURES

- Charging port cover
- Power/light mode button
- USB port (for use with USB charging cable and 120 volt AC/USB charging adapter)
- Battery/charge status LED indicator / translucent USB power button
- Rubber O-ring
- USB charging cable
- 120 volt AC/USB charging adapter (optional accessory)
- 120 volt AC/USB charging adapter USB port (optional accessory)

READING THE BATTERY/CHARGE STATUS LED INDICATOR

The battery/charge status LED indicator is located inside the translucent USB Power Button. It lights or flashes in two colors to indicate the following:

When charging:

- Blue:** Battery is in a fully charged state.
- Blue (flashing):** Battery is in a partially charged state.
- Red (flashing):** Battery needs to be recharged.

Red (flashing rapidly): The battery of the unit is overheated due to extensive use or recharging. The charging process will stop at this stage and will automatically resume after a cool down period.

When operating the USB port (once the translucent USB power button has been pressed):

- Blue:** Battery is operating at full voltage.
- Red:** Battery is operating at partial voltage.

Red (flashing rapidly):

- Battery is operating at extremely low voltage. The built-in low voltage protection has activated and the unit will automatically shut down. The unit must be recharged immediately. **OR**
- The battery of the unit is overheated (due to extensive use or recharging), or is too cool (the ambient temperature has dropped below -20°C). Operation will stop at this stage.

CHARGING/RECHARGING THE LIGHT

This unit is shipped in a partially charged state. Charge unit after purchase and BEFORE first use until the battery/charge status LED indicator lights blue.

Recharge after each use until the battery/charge status LED indicator lights blue.

IMPORTANT: When the unit is not in use, we recommend that the battery is charged at least every 3 to 6 months.

CAUTION: TO REDUCE THE RISK OF INJURY OR PROPERTY DAMAGE:

- Never place the light face down on any surface when charging.
- Make sure the light is turned OFF during recharging, as operating the light can slow the recharging process.
- Failure to keep the battery charged will cause permanent damage and result in poor performance.

Charging/recharging using the USB charging cable and a device with a USB power port (not supplied)

- Make sure the Power/Light Mode Button and the translucent USB power button are both turned off* (the light is not lit and the translucent USB power indicator/power button is not lit).
**The translucent button does not operate the light, only the USB power port.*
- Unscrew the charging port cover (counterclockwise) until the USB charging port is exposed.
- Insert the USB charging cable into the USB port on the light.
- Insert the other end of the USB charging cable into a device's functional USB power port. The battery/charge status LED indicator will light or flash in one of two colors (as described in the "Reading the Battery/Charge Status LED Indicator" section) to indicate the charging status.
- Charge until the battery/charge status LED indicator lights blue.
- When charging is complete, disconnect the USB charging cable from the device's USB power port and the light. Store the cable in a safe place.
- Screw the charging port cover back in place (clockwise) until it is finger tight. Make sure it fits securely, but do NOT overtighten.

Charging/recharging using the 120 Volt AC/USB Charging Adapter

- Make sure the Power/Light Mode Button and the translucent USB power button are both turned off* (the light is not lit and the translucent USB power indicator/power button is not lit).
**The translucent button does not operate the light, only the USB power port.*
- Unscrew the charging port cover (counterclockwise) until the USB charging port is exposed.
- Insert the USB charging cable into the USB port on the light.
- Insert the other end of the USB charging cable into the 120 volt AC/USB charging adapter.
- Insert the 120 volt AC/USB charging adapter into a functioning 120 volt AC power source. The battery/charge status LED indicator will light or flash in one of two colors (as described in the "Reading the Battery/Charge Status LED Indicator" section) to indicate the charging status.
- Charge until the battery/charge status LED indicator lights blue.
- When charging is complete, first unplug the 120 volt AC/USB charging adapter from the 120 volt AC power source, then disconnect the USB charging cable from the adapter and the light. Store the adapter and cable in a safe place.
- Screw the charging port cover back in place (clockwise) until it is finger tight. Make sure it fits securely, but do NOT overtighten.

OPERATING THE FLASHLIGHT

The power/light mode button is located at the bottom of the flashlight. It turns the flashlight on and off; and is also used to select high (bright), low (dimmer) and strobe (rapidly flashing) modes.

CAUTION – TO REDUCE THE RISK OF INJURY OR PROPERTY DAMAGE:

- Do not operate while charging.**
- Make sure the flashlight's USB port is turned off (the battery/charge status LED indicator is not lit) during operation.
- IMPORTANT – To protect the unit's internal battery from damage and save energy:**
 - If the Translucent USB Power Button is pressed to turn on the USB Port when the unit is operating in High Light Mode, the unit will switch automatically to Low Light Mode.
 - If the light's battery voltage is low, the unit will switch automatically to Low Light Mode even if High Light Mode has been selected.
 - If the light's battery voltage is very low, the built-in low voltage protection will activate after a short period of operation, then the unit will automatically shut down. This is a special feature to protect the unit's internal battery from damage. Recharge the battery before continuing use.

Notes: The Battery/Charge Status LED Indicator will not light during operation of the flashlight.

To check the battery status, make sure the flashlight is turned off, then press on the Translucent USB Power Button. The Battery/Charge Status LED Indicator will light or flash in one of two colors (as described in the "Reading the Battery/Charge Status LED Indicator" section) to indicate the internal battery status.

Operation

Disconnect the charging cable, then select the light mode as follows:

For High (Bright) Mode: To turn the flashlight on and use it in its highest (brightest) mode, press the power/light mode button once.

For Low (Dimmer) Mode: To use the flashlight in its lowest (dimmer) mode, press the power/light mode button a second time *within 5 seconds*.

For Strobe (Rapidly Flashing) Mode: To use the flashlight in strobe mode, press the power/light mode button a third time *within 5 seconds*. In this mode, the light will repeatedly emit the rapidly flashing signal (flashing 10 cycles per second).

To Turn the Flashlight Off: Press the power/light mode button a fourth time *within 5 seconds* OR press the power/light mode button once *after 5 seconds* in any mode.

OPERATING THE FLASHLIGHT'S USB PORT

The flashlight's USB port is located under the charging port cover. It provides 5 volts/1A of DC power to an external USB powered device.

- Make sure the flashlight is turned off.
- Unscrew the charging port cover (counterclockwise) until the USB port is exposed.

- Press the translucent USB power button to power on the USB port. The battery/charge status LED indicator will light or flash in one of two colors (as described in the "Reading the Battery/Charge Status LED Indicator" section) to indicate the internal battery status.
- Simply plug the USB device into the flashlight's USB port and operate normally.
- Press the translucent USB power button again to turn off the USB port. Make sure the translucent USB power button is in the off position (is not lit) when the unit is being recharged or stored.
- Screw the charge port cover back in place (clockwise) until it is finger tight. Make sure it fits securely, but do NOT overtighten.

IMPORTANT: If the USB port is in use, the light will only operate in Low or Strobe (Rapidly Flashing) Light Mode.

OPERATING THE 120 VOLT AC/USB CHARGING ADAPTER'S USB PORT

Plug the 120 volt AC/USB charging adapter into a (powered) standard North American 120 volt 60Hz outlet. Then simply plug the USB device into the USB outlet and operate normally.

WARNING – TO AVOID THE RISK OF PROPERTY DAMAGE: Always plug the 120 volt AC/USB charging adapter to the standard North American 120 volt 60Hz outlet before plugging any devices into it.

CARE AND MAINTENANCE

All batteries lose energy from self-discharge over time and more rapidly at higher temperatures. When the unit is not in use, we recommend that the battery is charged at least every 3 to 6 months.

If the unit gets dirty, gently clean the outer surfaces of the flashlight unit with a soft cloth moistened with a mild solution of water and detergent.

There are no user-replaceable parts. Periodically inspect the condition of connectors and wires. Contact manufacturer to replace any components that have become worn or broken.

Battery replacement/disposal

BATTERY REPLACEMENT

The battery should last the service life of the unit. Service life is dependent on a number of factors including but not limited to the number of recharge cycles, and proper care and maintenance of the battery by the end user. Contact manufacturer for any information you may need.

SAFE BATTERY DISPOSAL

Contains a lithium-ion battery, which must be disposed of properly. Recycling is required. Failure to comply with local, state and federal regulations can result in fines, or imprisonment. Please recycle.

WARNINGS:

- Do not dispose of the battery in fire as this may result in an explosion.
- Before disposing of the battery, protect exposed terminals with heavy-duty electrical tape to prevent shorting (shorting can result in injury or fire).
- Do not expose battery to fire or intense heat as it may explode.

TROUBLESHOOTING

The flashlight will not charge

- Check that the translucent USB power button is turned off.
- Check the connection to the flashlight and either the power source or the 120V AC/USB charging adapter. Make sure there is good contact.
- Confirm that there is functioning AC current OR make sure the USB power source is functioning properly.
- The unit may have shut down to protect the battery from overheating after a long period of operation or charging. Disconnect the USB charging cable from the light. Allow the light to cool down for a period before resuming charging.

The flashlight will not operate

- Make sure the power/light mode button has been pressed to turn the flashlight on.
- Check that the translucent USB power button is turned off.
- The internal battery may be completely discharged. Charge the unit following the directions given in this manual.
- The unit may have shut down to protect the battery from overheating after a long period of operation or charging; or the ambient temperature has dropped below -20°C. Allow the light to cool down or warm up for a period before resuming operation.

The flashlight's USB port will not operate

- Make sure the power/light mode button is turned off.
- Make sure the translucent USB power button is pressed to turn the USB port on.
- Make sure the rating of equipment plugged into the flashlight's USB port does not exceed 1A continuous.
- The internal battery may be completely discharged. Charge the unit following the directions given in this manual.
- Some household USB-powered electronics will not operate with this USB port. Check the manual of the corresponding electronic device to confirm that it can be used with this type of USB port.

The 120V AC/USB charging adapter's USB port will not operate

- Make sure you have live AC power to the outlet the 120V AC/USB charging adapter is plugged into.
- Make sure the rating of equipment plugged into the charging adapter's USB port does not exceed 1A continuous.
- Some household USB-powered electronics will not operate with this USB port. Check the manual of the corresponding electronic device to confirm that it can be used with this type of USB port.

If the unit does not charge or operate after taking the steps given above, contact the manufacturer at (877) 571-2391.

ACCESSORIES

Recommended accessories for use with this unit may be available from the manufacturer. If you need assistance regarding accessories, please contact manufacturer at 1-877-571-2391.

WARNING: The use of any accessory not recommended for use with this appliance could be hazardous.

SERVICE INFORMATION

Where you need technical advice, repair, or genuine factory replacement parts, contact the manufacturer at 877-571-2391.

ONE-YEAR LIMITED WARRANTY

The manufacturer warrants this product against defects in materials and workmanship for a period of ONE (1) YEAR from the date of retail purchase by the original end-user purchaser ("Warranty Period").

If there is a defect and a valid claim is received within the Warranty Period, the defective product can be replaced or repaired in the following ways: (1) Return the product to the manufacturer for repair or replacement at manufacturer's option. Proof of purchase may be required by manufacturer. (2) Return the product to the retailer where product was purchased for an exchange (provided that the store is a participating retailer). Returns to retailer should be made within the time period of the retailer's return policy for exchanges only (usually 30 to 90 days after the sale). Proof of purchase may be required. Please check with the retailer for their specific return policy regarding returns that are beyond the time set for exchanges.

This warranty does not apply to accessories, bulbs, fuses and batteries; defects resulting from normal wear and tear, accidents; damages sustained during shipping; alterations; unauthorized use or repair; neglect, misuse, abuse; and failure to follow instructions for care and maintenance for the product.

This warranty gives you, the original retail purchaser, specific legal rights and you may have other rights which vary from state to state or province to province. This product is not intended for commercial use.

Please complete the Product Registration Card and return within 30 days from purchase of the product to: Baccus Global LLC, One City Centre, 1 North Federal Highway, Suite 200, Boca Raton, FL 33432. **Baccus Global LLC, toll-free number: (877) 571-2391.**

SPECIFICATIONS

Flashlight (Conforms to UL STD.73)

Bulb: 10 watt LED bulb
Battery: Lithium-Ion, 3.6 V DC
Input: 5V DC, 1A
USB Output: 5V DC, 1A

120V AC/USB Charging Adapter (Conforms to UL STD. 62368-1) (Optional Accessory)

Input: 120V AC, 60Hz, 6.7W
Output: 5V DC, 1A

Imported by Baccus Global LLC, One City Centre, 1 North Federal Highway, Suite 200, Boca Raton, FL 33432
www.baccusglobal.com 1-877-571-2391
RD011718

